

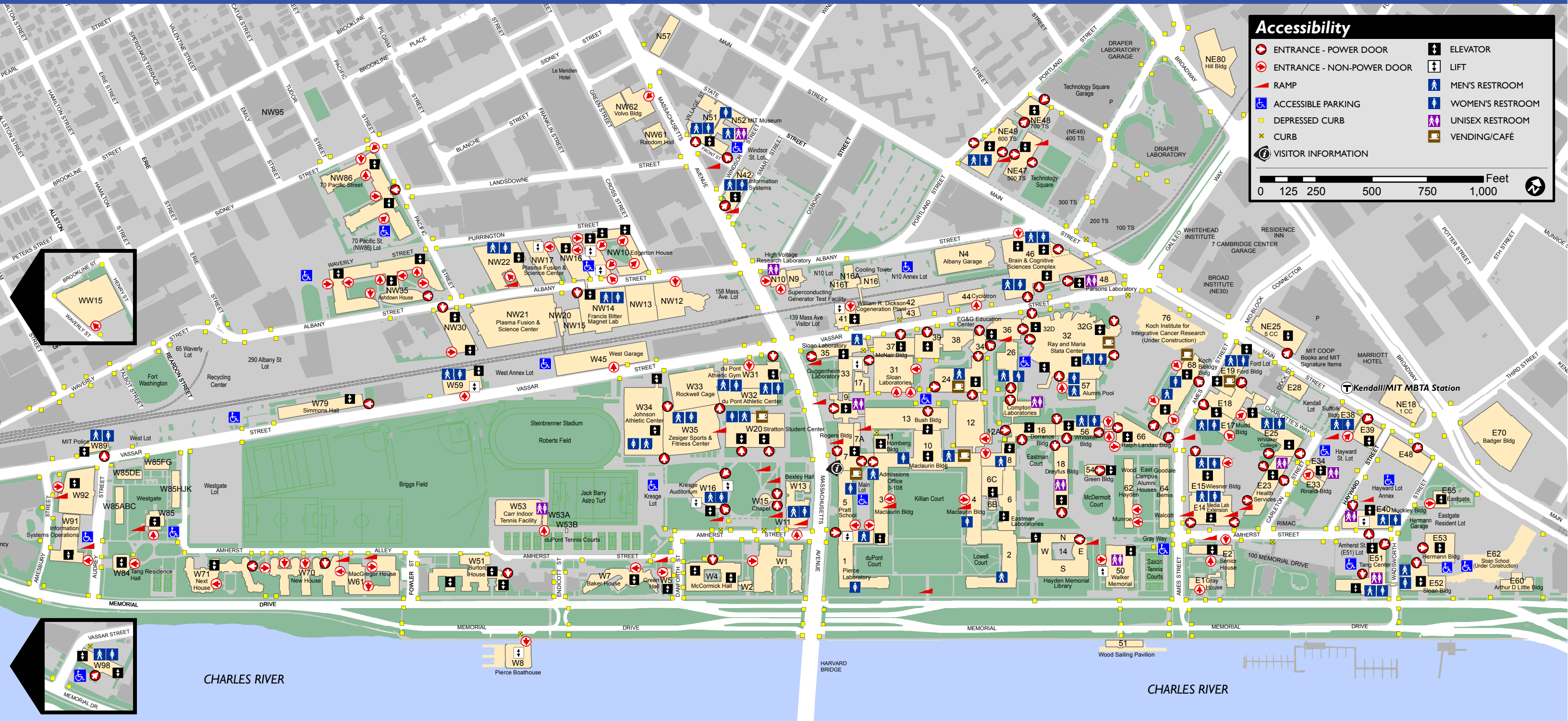













MIT CAMPUS ACCESSIBILITY MAP

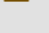

Accessibility

 ENTRANCE - POWER DOOR	 ELEVATOR
 ENTRANCE - NON-POWER DOOR	 LIFT
 RAMP	 MEN'S RESTROOM
 ACCESSIBLE PARKING	 WOMEN'S RESTROOM
 DEPRESSED CURB	 UNISEX RESTROOM
 CURB	 VENDING/CAFÉ
 VISITOR INFORMATION	

0 125 250 500 750 1,000 Feet



Access to MIT
 This guide presents the major means of physical access to MIT facilities, as well as the architectural barriers which may be encountered. Although this guide deals with the general needs of people with temporary or permanent mobility impairments, MIT is prepared to respond to other access requests.

Architectural Barriers
 If you encounter any barriers or have any requirements or recommendations relating to the physical environment, contact:
 MIT Facilities | NE49-2100 | 617-258-7011
 HR Disabilities Services Office for Employees | E19-215 | 617-253-4572
 Disabilities Services for Students | 7-145 | 617-253-1674

Parking
 Parking at MIT is by permit only. Designated accessible parking also requires an HP plate. If you do not have an HP Plate and special parking arrangements are required, you may contact:
 MIT Parking & Transportation Office
 W20-022 | 617-258-6510
 MIT Medical Occupational Health
 617-253-8852

Snow Removal
 If additional snow removal is needed contact:
 Grounds Services | NW62 | 617-253-6350

Department of Athletics, Physical Education and Recreation (DAPER)
 W34/W35 Main Customer Service Desk | 617-452-3690

Housing
 617-258-5488













Inaccessible Buildings
 Bexley Hall, W13 | Random Hall, NW61 | Sailing Pavilion, 51

Visitor Information ⓘ (M-F, 9AM - 5PM)
 For copies of this map or more information about MIT, please visit the MIT Information Center, Room 7-121, located in the main entrance lobby (Lobby 7) | 617-253-4795

MAIN GROUP ACCESSIBILITY

Many of the **MAIN GROUP** and **NORTH GROUP** buildings are interconnected to allow access between buildings. The maps on this page depict these connections for floors basement through five. Please note that floors in the **MAIN GROUP** are numbered one floor lower than **NORTH GROUP** floors at the same level.

LEGEND

-  ENTRANCE - POWER DOOR
-  ENTRANCE - NON-POWER DOOR
-  RAMP
-  ACCESSIBLE PARKING
-  VENDING/CAFÉ
-  VISITOR INFORMATION
-  ELEVATOR
-  LIFT
-  WOMEN'S RESTROOM
-  MEN'S RESTROOM
-  UNISEX RESTROOM
-  ACCESSIBLE ROUTES THROUGH BUILDINGS
-  ACCESSIBLE ROUTES THROUGH TUNNELS



MIT CAMPUS ACCESSIBILITY MAP

BASEMENT

NORTH GROUP
MAIN GROUP

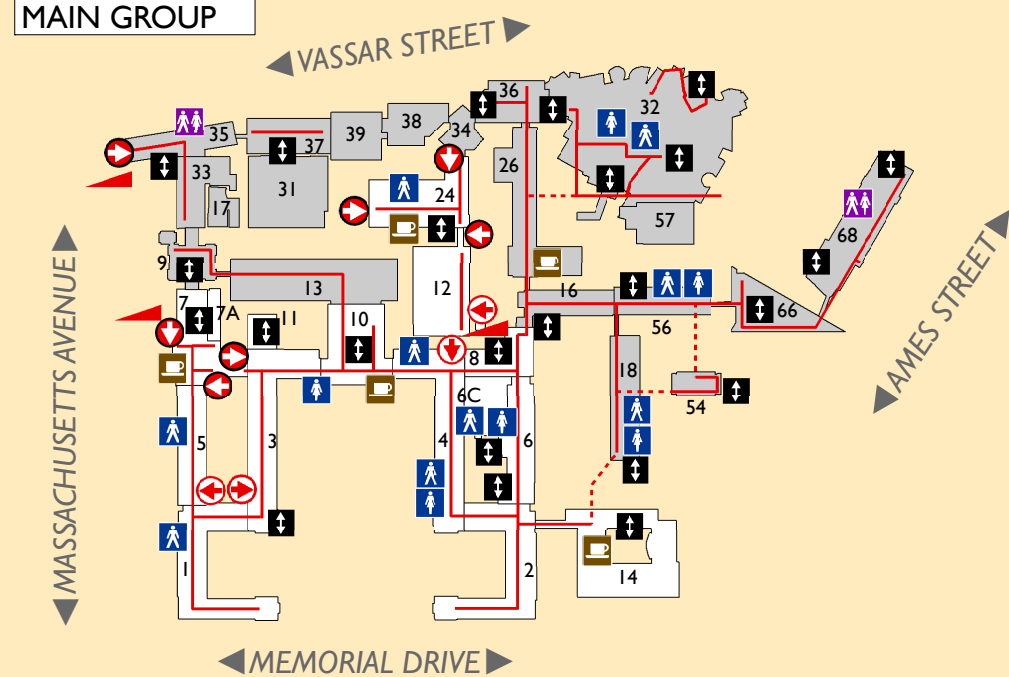

FLOOR 1

NORTH GROUP
MAIN GROUP

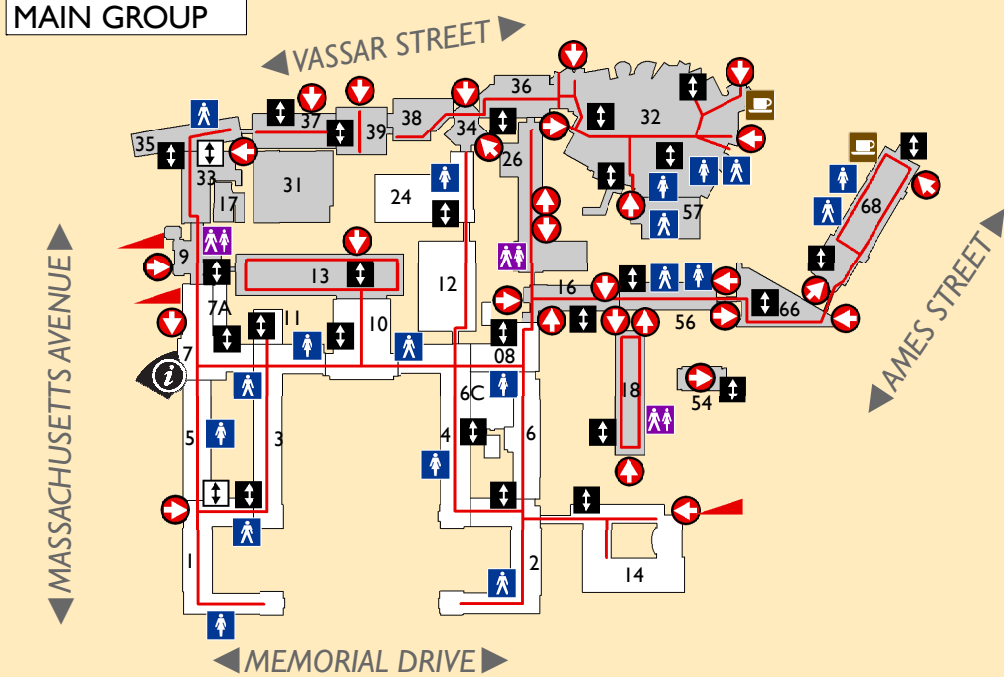

FLOOR 2

NORTH GROUP
MAIN GROUP

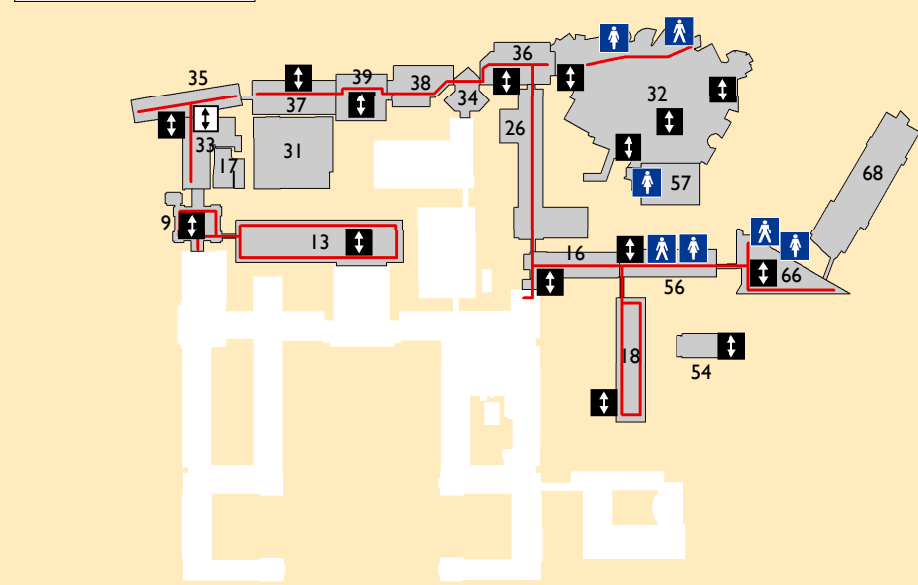

FLOOR 3

NORTH GROUP
FLOOR 2
MAIN GROUP

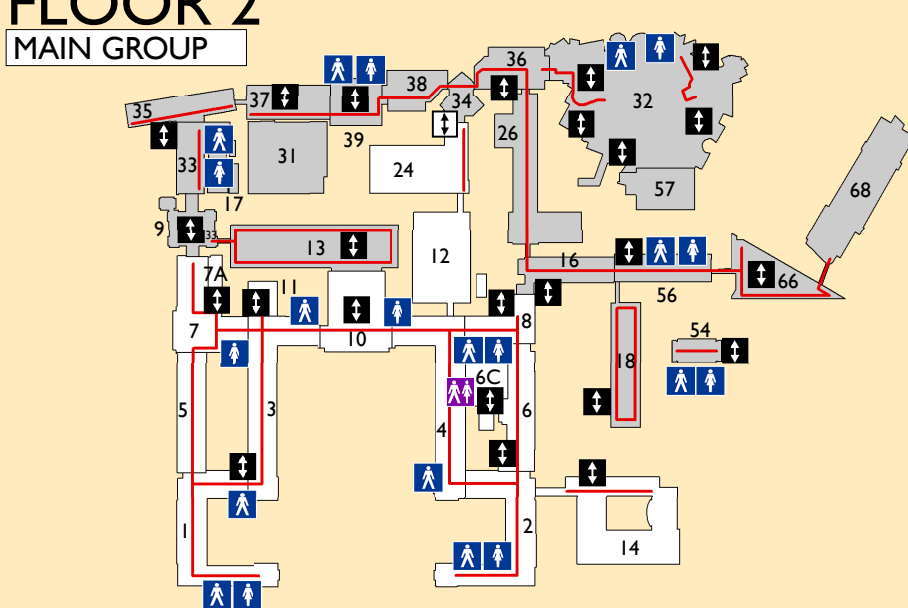

FLOOR 4

NORTH GROUP
FLOOR 3
MAIN GROUP

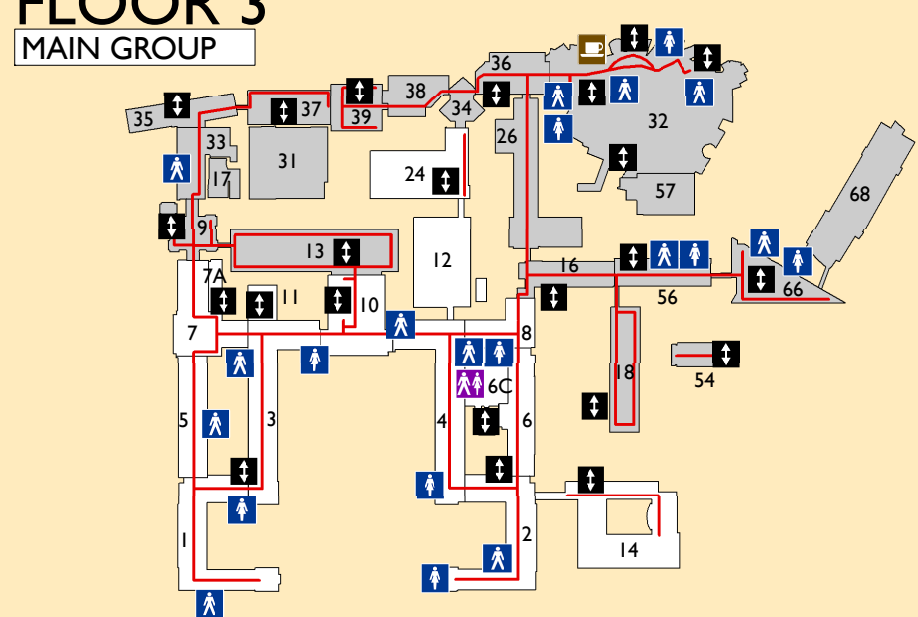

FLOOR 5

NORTH GROUP
FLOOR 4
MAIN GROUP

